

3.8%
Interest Mortgages Fixed
3 years available



Santander

Up to 95% Mortgages Available*

Residencial



An ideal home for tranquil living

PARQUE REAL

San Miguel

44 Exclusively built homes by the locally renowned constructor **AleDan S.L.**
Designed by award winning architect **Luis Cabezas Lopez**



A rare opportunity to purchase a home in a country town. To be able to take advantage of life in the semi rural sleepy village of *San Miguel* where time stands still is a very rare commodity.

Rarely does does this occur to own an apartment in such tranquil surroundings as *San Miguel*.



Residencial *Parque Real* is situated conveniently away from the centre and is elevated to take advantage of the splendid panoramic views.

San Miguel is a town where village life has remained how it used to be and is within 15 minutes drive to every amenity including the International Reina Sofia airport, schools, entertainment, shops, supermarket and beach.



All this together with an apartment built to excellent standards of quality.



- All 2 bed apartments will have ensuite bathrooms to the master bedroom.
- Nine apartments have their own private garden area.
- Every apartment to have secure underground carparking space.
- Entry accessed car parking and storage.
- Built in wardrobes in all bedrooms.
- A roof area is accessible to all apartments should you wish to take advantage of the magnificent views or maybe just relax.
- Double glazed windows & security shutters





KITCHEN



- Luxury fitted kitchen including:-
Integrated appliances
- Hob & oven, fridge/freezer, washer /dryer.
(french doors opening onto balconies
where applicable)



BATHROOM

- White sanitary ware with
Grohe taps.
- Large white wash hand basins.
with integrated baths and showers
Co-ordinated tiles

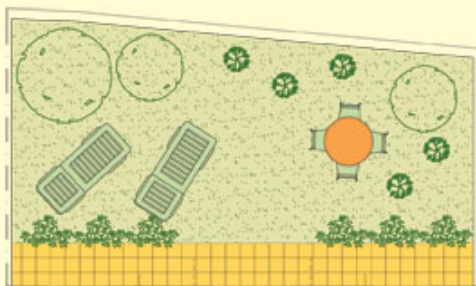

VIVIENDA- A



SUPERFICIE CONSTRUIDA:	69,79 m ²
SUPERFICIE ÚTIL:	61,17 m ²
SUPERFICIE JARDÍN (no computable):	51,87 m ²

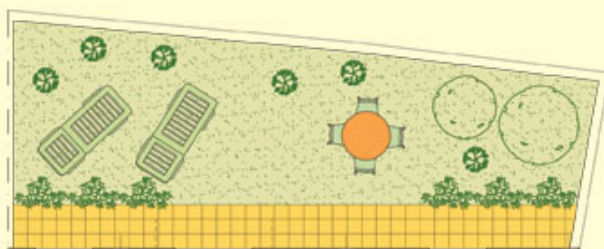

VIVIENDA- B



SUPERFICIE CONSTRUIDA:	72,95 m ²
SUPERFICIE ÚTIL:	63,75 m ²
SUPERFICIE JARDÍN (no computable):	52,38 m ²

VIVIENDA- C

SUPERFICIE CONSTRUIDA:	44,83 m ²
SUPERFICIE ÚTIL:	39,95 m ²



VIVIENDA- D

SUPERFICIE CONSTRUIDA:	72,42 m ²
SUPERFICIE ÚTIL:	63,25 m ²



SUPERFICIE CONSTRUIDA:	71,11 m ²
SUPERFICIE ÚTIL:	61,75 m ²

VIVIENDA- E



Residencial PARQUE REAL

An ideal home for tranquil living



San Miguel Sales & Information

S.I.B.N.I
Tel/Fax 922 70 13 10
Mov. 637 40 66 76
sibnitenerife@hotmail.com

AleDan
Tel 922 16 73 80
info@aledan.es

Ron Eastwood
Mob. 652 937 929
Email: Ron.eastwood@telefonica.net



Castig S.L. se reserva el derecho de modificar sin previo aviso las técnicas, características y acabados de calidades y make of the products shown on the present catalogue. Castig S.L. is not responsible for mistakes of impression (coloration) or for differences of tonality, colour on the photographic reproduction of the products.